

Senate

COMMITTEE ON FEDERAL, STATE AND LOCAL GOVERNMENTS

Minutes of Meeting -- March 30, 1971

A special meeting of the Committee on Federal, State and Local Governments was held on the 30th day of March, 1971 at 5:00 P.M. concerning reapportionment.

Committee members present: James I. Gibson
Coe Swobe
Stan Drakulich
Warren L. Monroe
Carl F. Dodge
Lee Walker

Also present were:

Mel Close, Senator
Mahlon Brown, Senator
John Foley, Senator
Cliff Young, Senator
Thomas Wilson, Senator
Perry Burnett, Legislative Counsel Bureau
Art Palmer, Legislative Counsel Bureau
Fred Dugger, Central Data Processing
Professor A. Maurice Beesley, Mathematics, University of Nevada Press

Mr. Art Palmer gave a presentation to the committee on the work that has been done to date with the computer programming regarding reapportionment. He distributed several maps and tables illustrating some of the different solutions, copies of which are attached hereto. This was followed by a presentation from Mr. Fred Dugger of Central Data Processing, who further explained the work that had been done up to this time. He noted that once the legislature has decided on the criteria to be used, the computer can build on this.

There was some discussion regarding the criteria and guidelines that would have to be set up before there could be any further computer programming. Some of them mentioned were: (1) county lines; (2) township lines; (3) size of house; (4) single-member districts; (5) multi-member districts; or (6) combination of single and multi-member districts; and (7) community of interest. Dr. Beesley pointed out that some possibilities just won't work and it takes a lot of work to find out which ones they are.

3-88

Senate Committee on Federal, State, and Local Governments

March 30, 1971

Mr. Perry Burnett of the Legislative Counsel Bureau gave a presentation to the committee. He stated that currently 39 states are trying to reapportion. He stressed that if the reapportionment is challenged the courts demand exactitude and the criteria which brought it to pass, so that all this preliminary work and study is not wasted time. Twelve states out of the 39 have announced that all districting will be based on the single-member districts. There was considerable discussion as to the court cases that are currently being decided on reapportionment, as well as other phases of reapportionment.

Mr. Palmer suggested that future requests for maps be channeled through one committee, to save money and duplication of requests. There have already been enough combinations run through the computer to give a wide variety of possibilities to be considered. Chairman Gibson again noted that there should be a meeting of the Senate as a committee of the whole, and they would have to decide on the criteria to be used.

There being no further business, the meeting was adjourned.

Respectfully submitted,

Mary Jean Fondl,
Committee Secretary

(20) SENATE - RURAL COUNTY SINGLE DISTRICTS

3-89
8

O R E G O N I D A H O

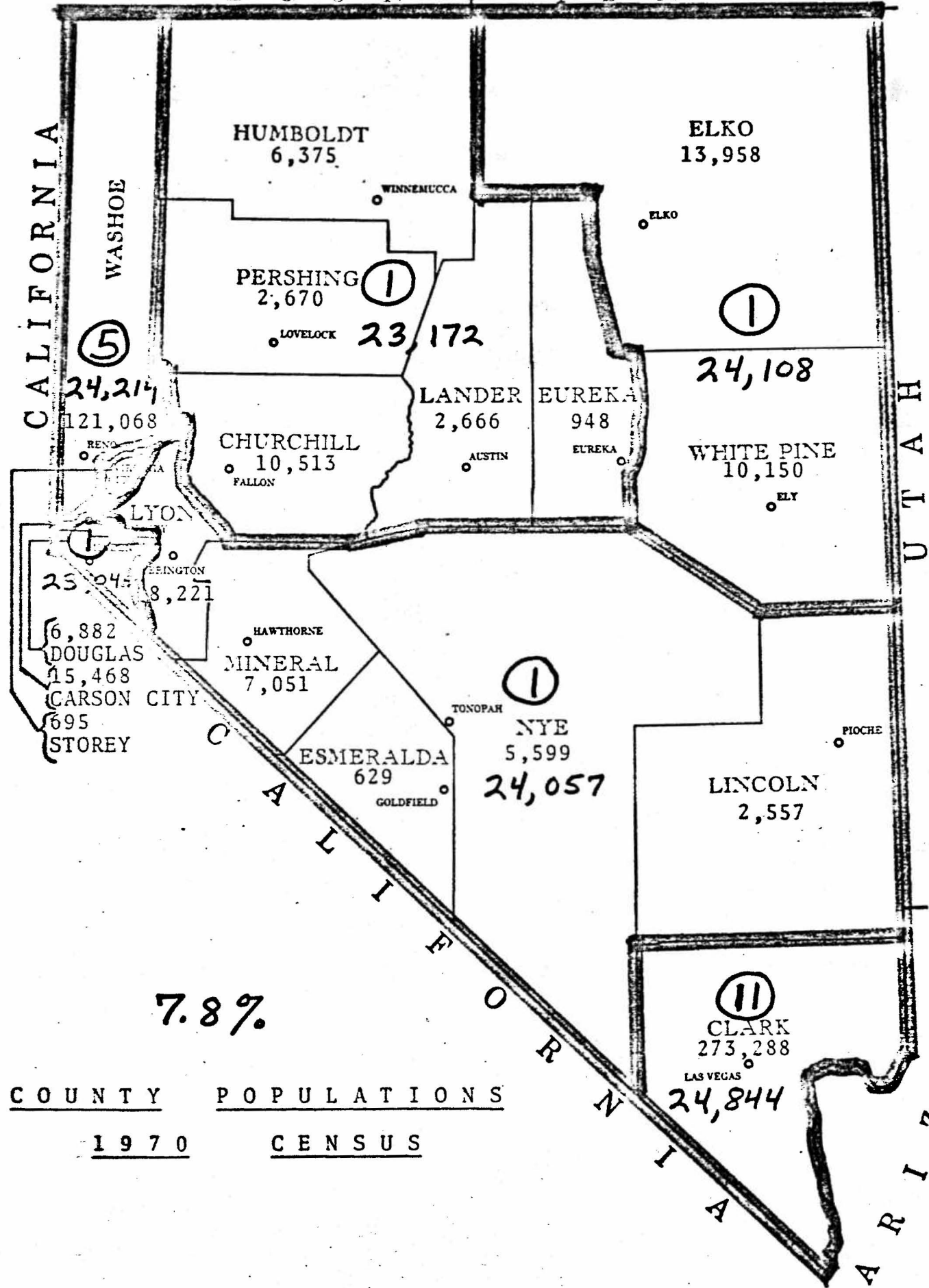

7.8%

COUNTY POPULATIONS
1970 CENSUS

O R E G O N I D A H O

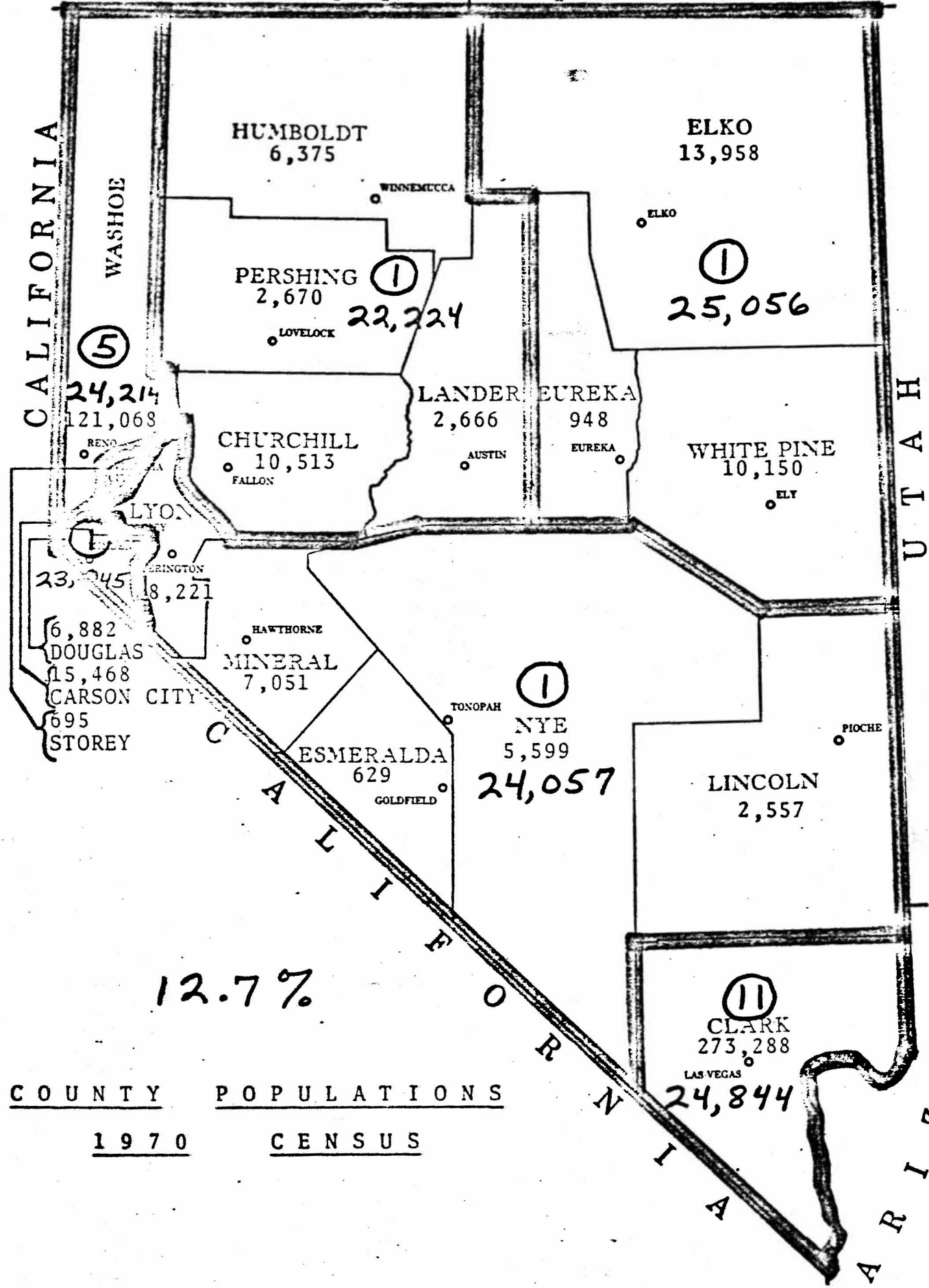

12.7%

COUNTY POPULATIONS
1970 CENSUS

O R E G O N I D A H O

C A L I F O R N I A

W A S H O E

HUMBOLDT
6,375

ELKO
13,958

PERSHING
2,670

ELKO

①

25,056

LOVELOCK

①

⑤

24,214

21,068

22,099

BLANDER EUREKA

2,666

948

CHURCHILL
10,513
FALLON

AUSTIN

EUREKA

WHITE PINE
10,150

ELY

LYON

22,356

18,221

①

24,877

6,882

DOUGLAS

15,468

CARSON CITY

695

STOREY

HAWTHORNE

MINERAL
7,051

TONOPAH

NYE

5,599

ESMERALDA

629

GOLDFIELD

PIOCHE

LINCOLN

2,557

13.4%

⑪

CLARK
273,288

LAS VEGAS

24,844

C O U N T Y P O P U L A T I O N S

1 9 7 0

C E N S U S

A R I Z O N A

O R E G O N I D A H O

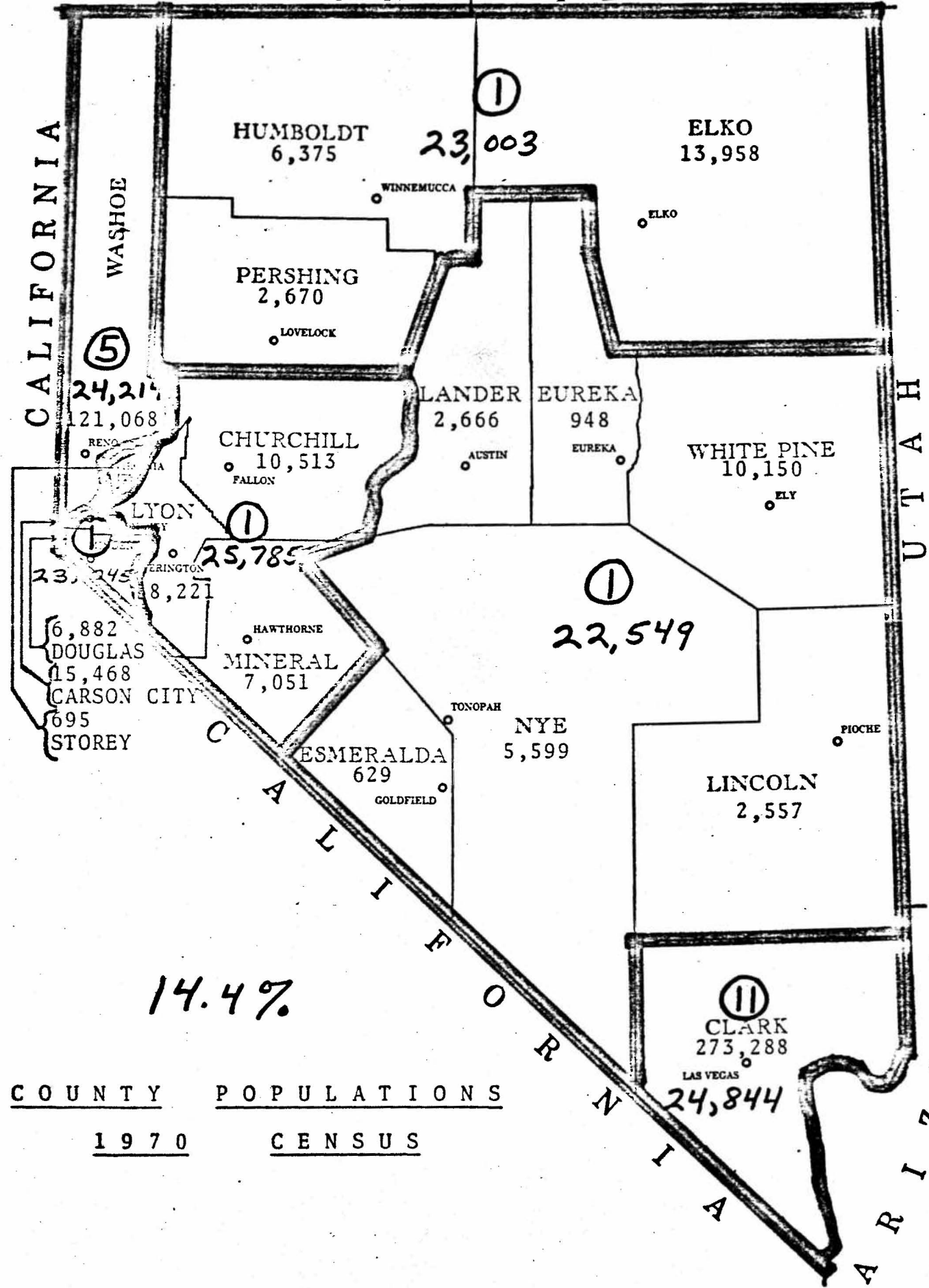

COUNTY POPULATIONS
1970 CENSUS

CALIFORNIA

WASHOE

HUMBOLDT
6,375

①
23,003

ELKO
13,958

PERSHING
2,670

⑤
24,214

BLANDER EUREKA
2,666 948

CHURCHILL
10,513

WHITE PINE
10,150

①
23,245

LYON
25,785

①
22,549

6,882
DOUGLAS
15,468
CARSON CITY
695
STOREY

HAWTHORNE
MINERAL
7,051

NYE
5,599

ESMERALDA
629

LINCOLN
2,557

14.4%

⑪
CLARK
273,288
LAS VEGAS
24,844

UTAH
ARIZONA

O R E G O N I D A H O

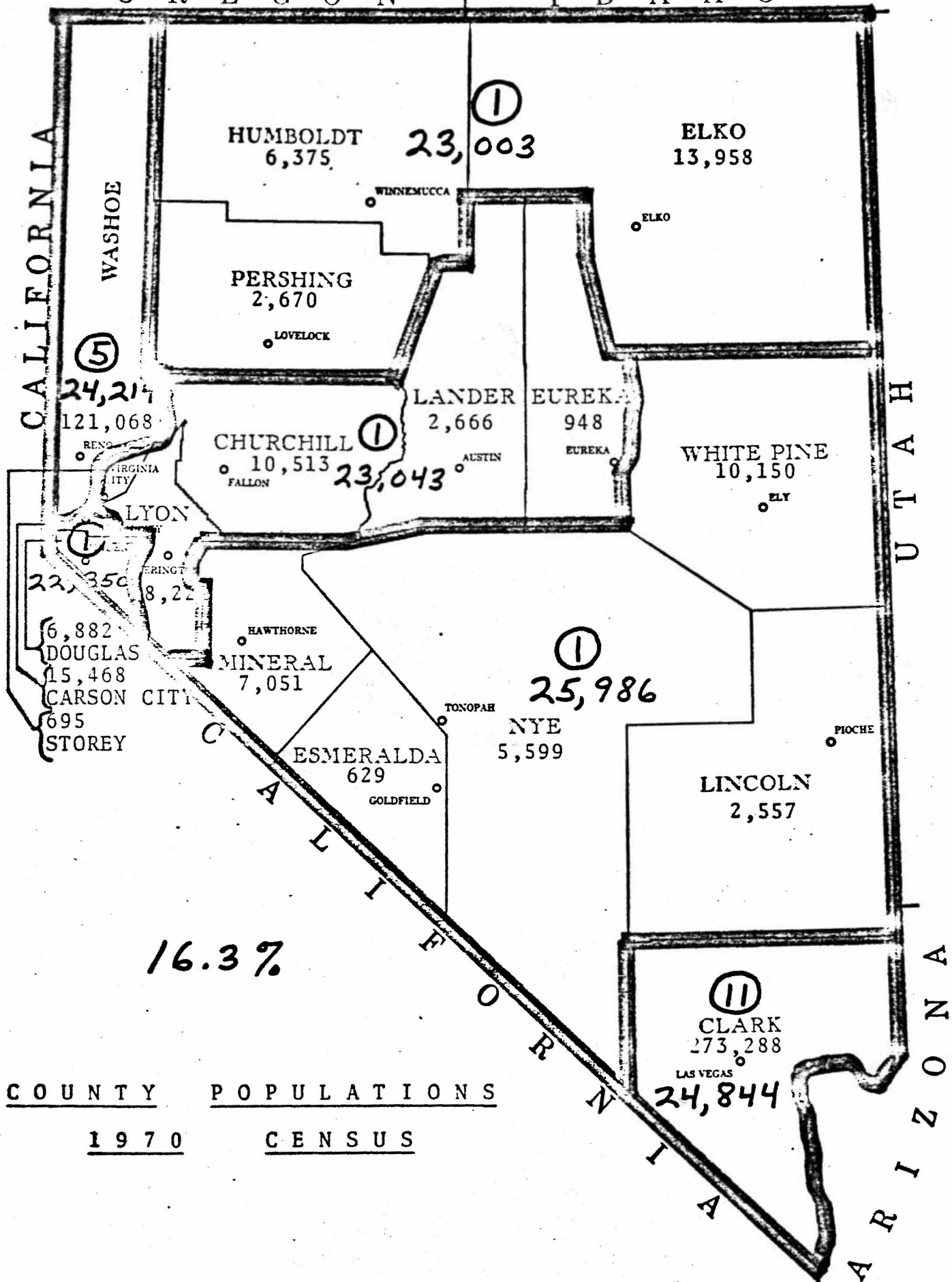

16.3%

COUNTY POPULATIONS
1970 CENSUS

O R E G O N I D A H O

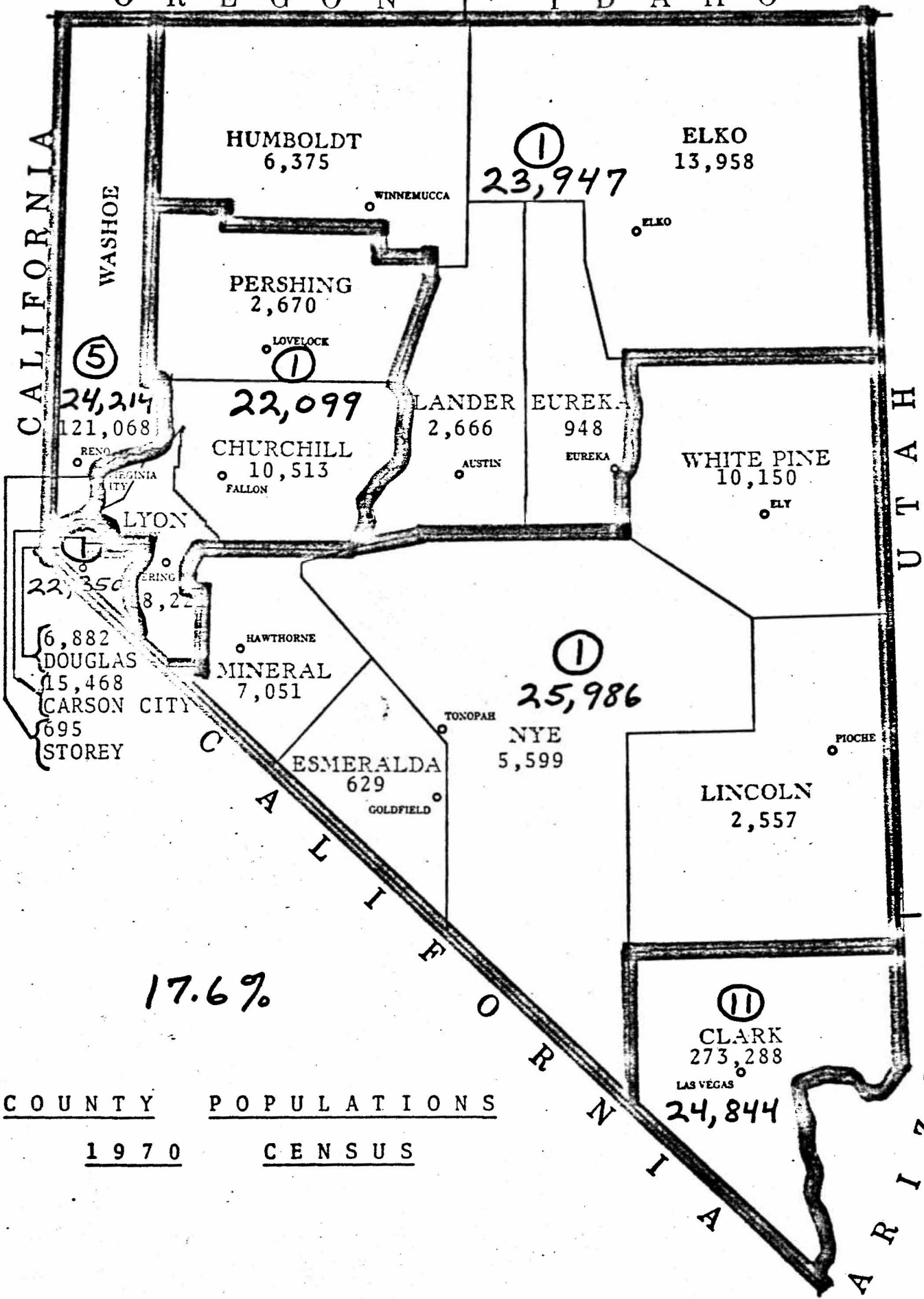

COUNTY POPULATIONS
1970 CENSUS

CALIFORNIA

UTAH

CALIFORNIA

ARIZONA

O R E G O N I D A H O

CALIFORNIA

WASHOE

RENO

LYON

DOUGLAS
CARSON CITY
STOREY

①

⑤

①

①

①

②

HUMBOLDT
6,375

23,951

ELKO
13,958

PERSHING
2,670

LANDER
2,666

CHURCHILL
10,513

22,095

EUREKA
948

WHITE PINE
10,150

6,882
DOUGLAS
15,468
CARSON CITY
695
STOREY

MINERAL
7,051

25,986

NYE
5,599

ESMERALDA
629

LINCOLN
2,557

17.6%

CLARK
273,288

24,844

COUNTY POPULATIONS
1970 CENSUS

UTAH

ARIZONA

O R E G O N I D A H O

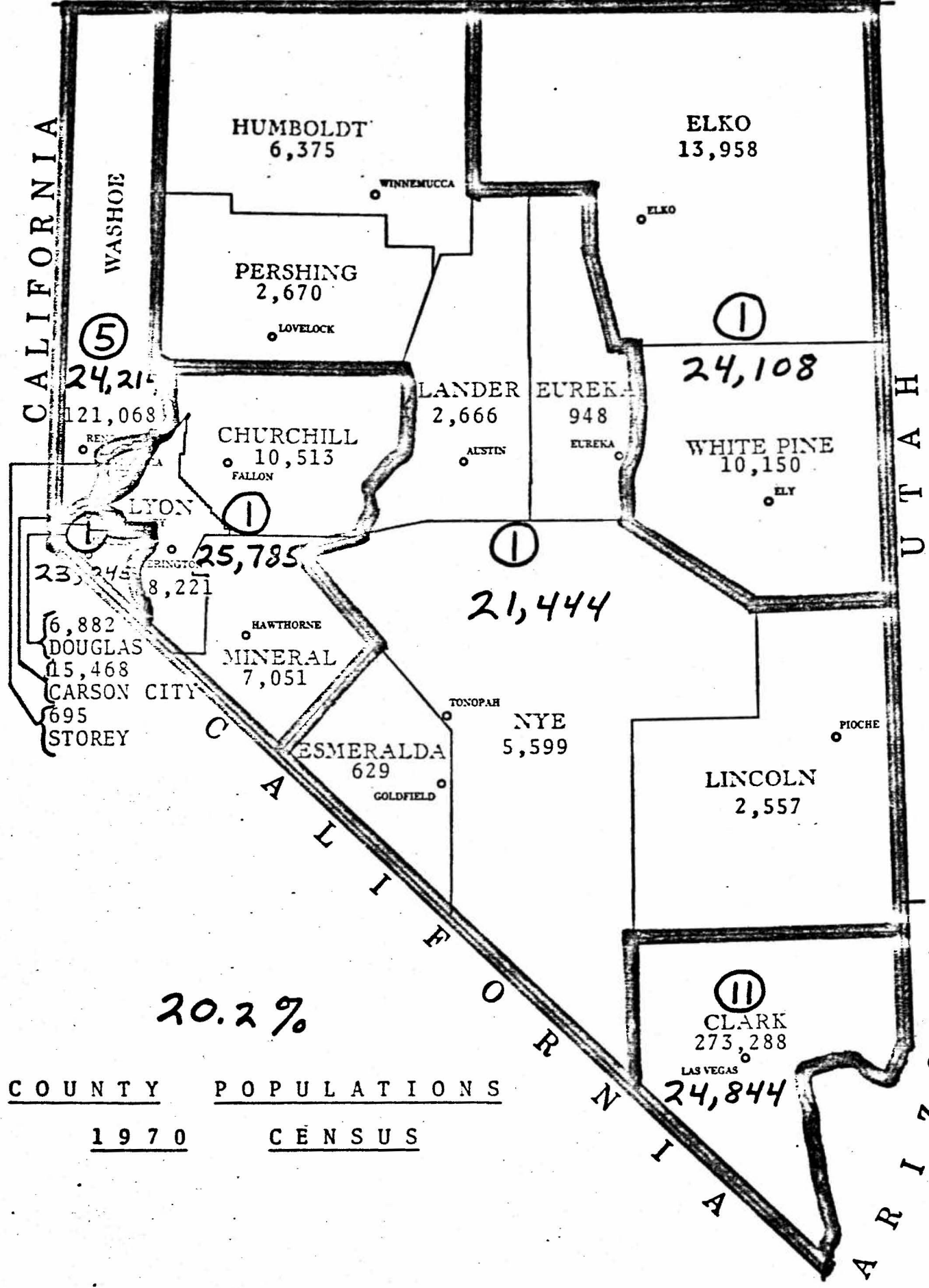

COUNTY POPULATIONS
1970 CENSUS

(18) SENATORS

AVERAGE

TRICT

27,152 3-97

O R E G O N I D A H O

CALIFORNIA

WASHOE

HUMBOLDT
6,375

ELKO
13,958

WINNEMUCCA

26,617

PERSHING
2,670

LOVELOCK

5

27,307

121,068

RENO

VIRGINIA CITY

LYON

MINNESOTA CITY

YERING

8,222

6,882

DOUGLAS

15,468

CARSON CITY

695

STOREY

CHURCHILL
10,513

FALLON
26,311

BLANDER
2,666

AUSTIN

EUREKA
948

EUREKA

WHITE PINE
10,150

ELY

1

25,986

HAWTHORNE

MINERAL
7,051

TONOPAH

NYE
5,599

ESMERALDA
629

GOLDFIELD

PIOCHE

LINCOLN
2,557

10

CLARK
273,288

LAS VEGAS

27,329

COUNTY POPULATIONS

1970

CENSUS

5.2%

+ 0.7%
- 4.5%

UTAH

CALIFORNIA

CALIFORNIA

CALIFORNIA

CALIFORNIA

CALIFORNIA

CALIFORNIA

CALIFORNIA

CALIFORNIA

CALIFORNIA

CALIFORNIA

CALIFORNIA

CALIFORNIA

CALIFORNIA

CALIFORNIA

CALIFORNIA

CALIFORNIA

CALIFORNIA

CALIFORNIA

CALIFORNIA

CALIFORNIA

CALIFORNIA

CALIFORNIA

CALIFORNIA

CALIFORNIA

CALIFORNIA

CALIFORNIA

CALIFORNIA

CALIFORNIA

CALIFORNIA

CALIFORNIA

CALIFORNIA

CALIFORNIA

CALIFORNIA

CALIFORNIA

CALIFORNIA

CALIFORNIA

CALIFORNIA

CALIFORNIA

CALIFORNIA

CALIFORNIA

CALIFORNIA

CALIFORNIA

CALIFORNIA

CALIFORNIA

CALIFORNIA

CALIFORNIA

CALIFORNIA

CALIFORNIA

CALIFORNIA

CALIFORNIA

CALIFORNIA

CALIFORNIA

CALIFORNIA

CALIFORNIA

CALIFORNIA

CALIFORNIA

CALIFORNIA

CALIFORNIA

CALIFORNIA

CALIFORNIA

CALIFORNIA

CALIFORNIA

CALIFORNIA

CALIFORNIA

CALIFORNIA

CALIFORNIA

CALIFORNIA

CALIFORNIA

CALIFORNIA

CALIFORNIA

CALIFORNIA

CALIFORNIA

CALIFORNIA

CALIFORNIA

CALIFORNIA

CALIFORNIA

CALIFORNIA

CALIFORNIA

CALIFORNIA

CALIFORNIA

CALIFORNIA

CALIFORNIA

CALIFORNIA

CALIFORNIA

CALIFORNIA

CALIFORNIA

CALIFORNIA

CALIFORNIA

CALIFORNIA

CALIFORNIA

CALIFORNIA

CALIFORNIA

CALIFORNIA

CALIFORNIA

CALIFORNIA

CALIFORNIA

CALIFORNIA

CALIFORNIA

CALIFORNIA

CALIFORNIA

CALIFORNIA

CALIFORNIA

CALIFORNIA

CALIFORNIA

CALIFORNIA

CALIFORNIA

CALIFORNIA

CALIFORNIA

CALIFORNIA

CALIFORNIA

CALIFORNIA

CALIFORNIA

CALIFORNIA

CALIFORNIA

CALIFORNIA

CALIFORNIA

CALIFORNIA

CALIFORNIA

CALIFORNIA

CALIFORNIA

CALIFORNIA

CALIFORNIA

ARIZONA

NEVADA

NEVADA

NEVADA

NEVADA

NEVADA

NEVADA

NEVADA

NEVADA

NEVADA

NEVADA

NEVADA

NEVADA

NEVADA

NEVADA

NEVADA

NEVADA

NEVADA

NEVADA

NEVADA

NEVADA

NEVADA

NEVADA

NEVADA

NEVADA

NEVADA

NEVADA

NEVADA

NEVADA

NEVADA

NEVADA

NEVADA

NEVADA

NEVADA

NEVADA

NEVADA

NEVADA

NEVADA

NEVADA

NEVADA

NEVADA

NEVADA

NEVADA

NEVADA

NEVADA

NEVADA

NEVADA

NEVADA

NEVADA

NEVADA

NEVADA

NEVADA

NEVADA

NEVADA

NEVADA

NEVADA

NEVADA

NEVADA

NEVADA

NEVADA

NEVADA

NEVADA

NEVADA

NEVADA

NEVADA

NEVADA

NEVADA

NEVADA

NEVADA

NEVADA

NEVADA

NEVADA

NEVADA

NEVADA

NEVADA

NEVADA

NEVADA

NEVADA

NEVADA

NEVADA

NEVADA

NEVADA

NEVADA

NEVADA

NEVADA

NEVADA

NEVADA

NEVADA

NEVADA

NEVADA

NEVADA

NEVADA

NEVADA

NEVADA

NEVADA

NEVADA

NEVADA

NEVADA

NEVADA

NEVADA

NEVADA

NEVADA

NEVADA

NEVADA

NEVADA

NEVADA

NEVADA

NEVADA

NEVADA

NEVADA

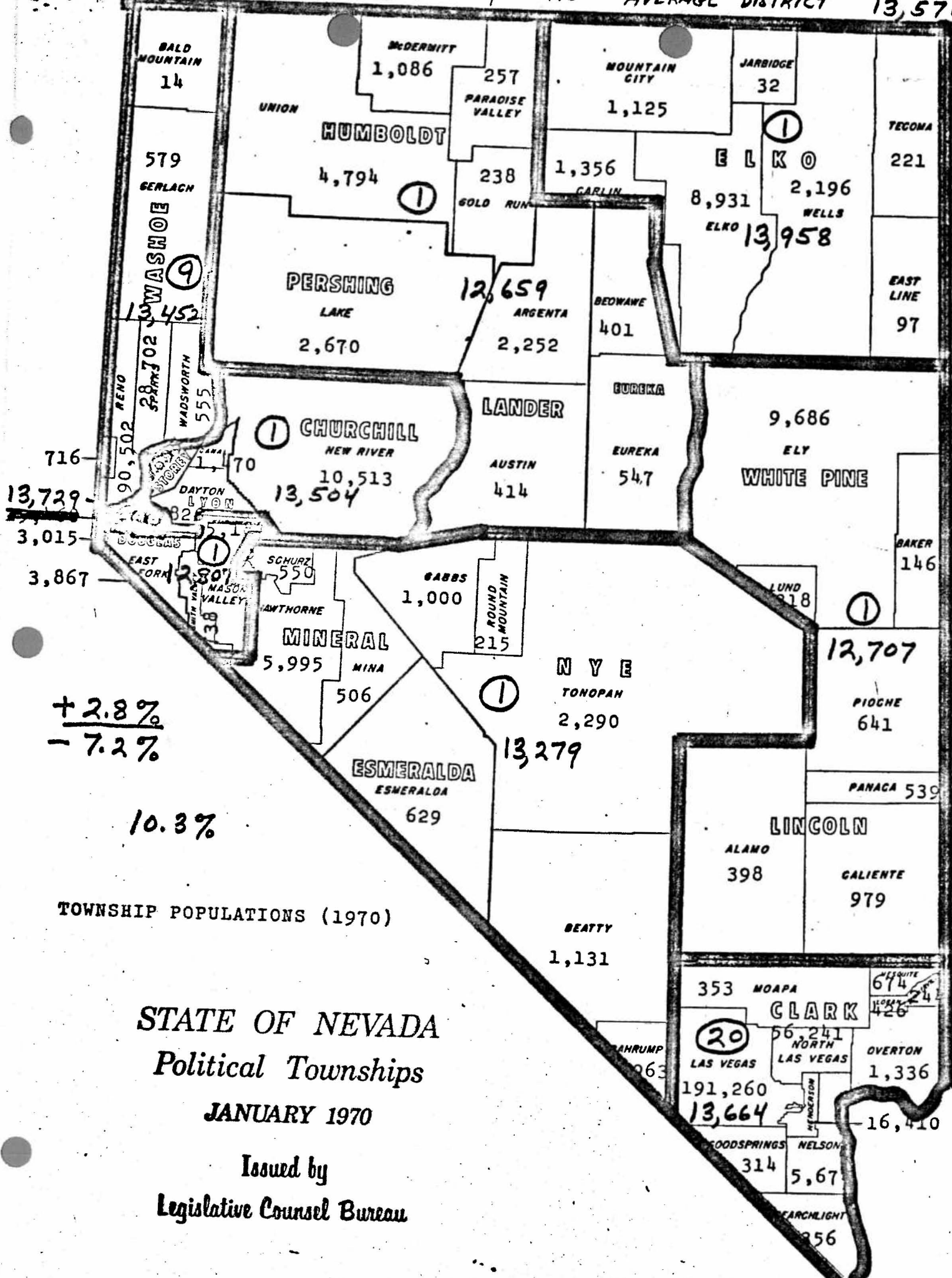

716
~~13,729~~
 3,015
 3,867

+ 2.8%
 - 7.2%

10.3%

TOWNSHIP POPULATIONS (1970)

STATE OF NEVADA
 Political Townships
 JANUARY 1970

Issued by
 Legislative Counsel Bureau

(L10) Assembly — (● rural county assembly ●) ts Av. Dist 12,218

O R E G O N | I D A H O

3-99
H

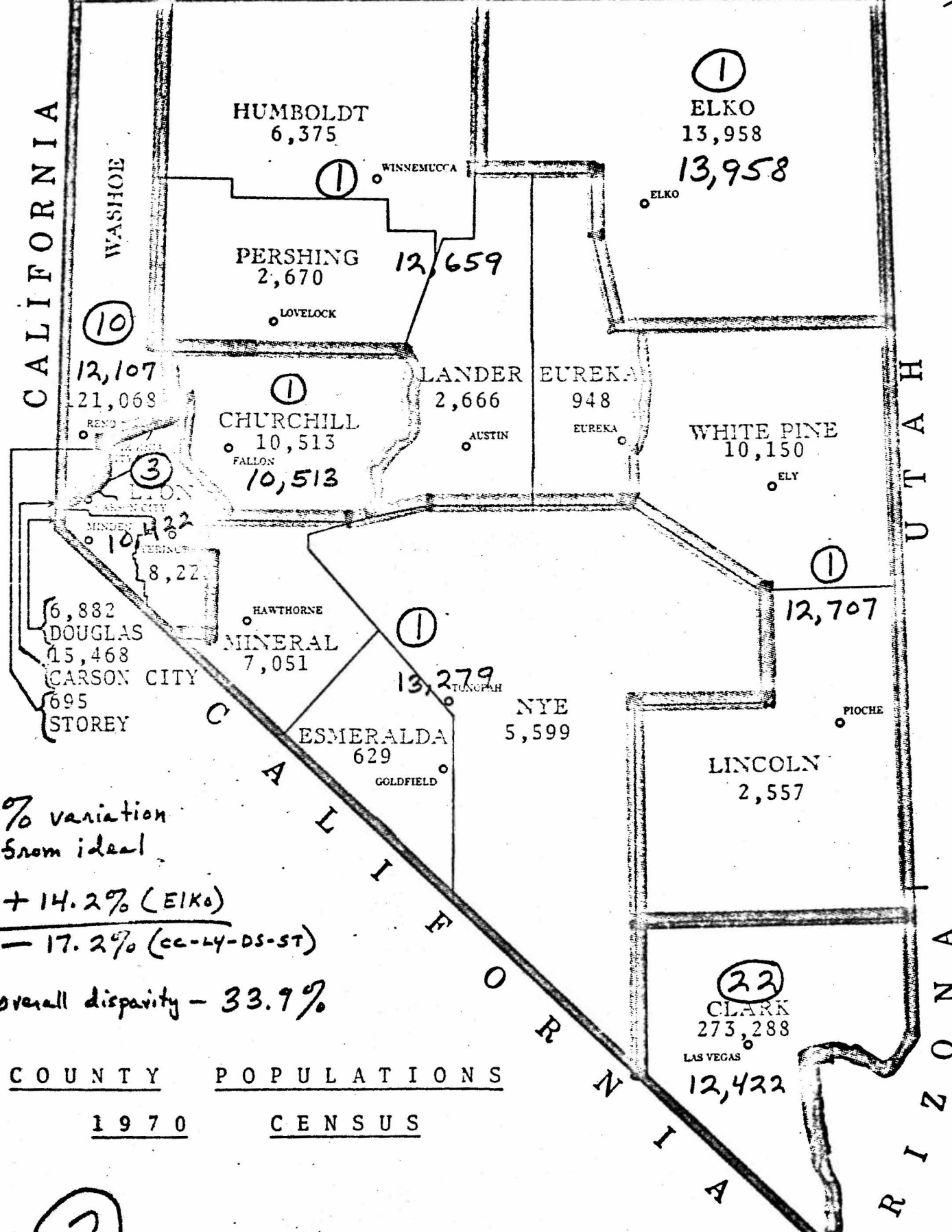

% variation from ideal
 + 14.2% (Elko)
 - 17.2% (cc-24-DS-ST)
 overall disparity - 33.9%

COUNTY POPULATIONS
 1970 CENSUS

(3)

C A L I F O R N I A
 W A S H O E
 U T A H
 A R I Z O N A

1970 LEGISLATIVE DISTRICT AVERAGE SIZE

[The average population a legislative district would have is related to the total number of seats in the respective house. The table below indicates the size of an average district for either the assembly or senate.]

<u>Seats</u>	<u>Population</u>	<u>Seats</u>	<u>Population</u>
1	488,738	29	16,853
2	244,369	30	16,291
3	162,913	31	15,766
4	122,185	32	15,273
5	97,748	33	14,810
6	81,456	34	14,375
7	69,820	35	13,964
8	61,092	36	13,576
9	54,304	37	13,209
10	48,874	38	12,862
11	44,431	39	12,532
12	40,728	40	12,218
13	37,595	41	11,920
14	34,910	42	11,637
15	32,583	43	11,366
16	30,546	44	11,108
17	28,749	45	10,861
18	27,152	46	10,625
19	25,723	47	10,399
20	24,437	48	10,182
21	23,273	49	9,974
22	22,215	50	9,775
23	21,249	51	9,583
24	20,364	52	9,399
25	19,550 Senate Maximum	53	9,221
26	18,798	54	9,051
27	18,101	55	8,886
28	17,455	56	8,727 Assembly Maximum

1970 PRIORITY LIST--FINAL POPULATION COUNT

[Priority numbers obtained from the table of multipliers arranged in decreasing order provide a guide to how many seats these arbitrary districts would have in any size house from one to 56 (the maximum for the assembly).]

<u>Seat</u>				<u>Percent Clark County Control</u>
1	Clark County	1st	273,288	
2	Clark County	2nd	193,244	
3	Washoe County	1st	121,068	
4	Clark County	3rd	111,569	
5	Balance of State	1st	94,382	→ 60%
6	Washoe County	2nd	85,608	→ 50%
7	Clark County	4th	78,891	57%
8	Balance of State	2nd	66,738	→ 50%
9	Clark County	5th	61,109	55-1/2%
10	Clark County	6th	49,895	→ 60%
11	Washoe County	3rd	49,426	54-1/2%
12	Clark County	7th	42,169	58%
13	Balance of State	3rd	38,531	54%
14	Clark County	8th	36,520	57%
15	Washoe County	4th	34,949	→ 53%
16	Clark County	9th	32,207	56%
17	Clark County	10th	28,807	→ 59%
18	Balance of State	4th	27,246	55-1/2%
19	Washoe County	5th	27,072	→ 52-1/2%
20	Clark County	11th	26,057	55%
21	Clark County	12th	23,787	57%
22	Washoe County	6th	22,104	54-1/2%
23	Clark County	13th	21,881	56-1/2%
24	Balance of State	5th	21,104	54%
25	Clark County	14th	20,257	56%
26	Clark County	15th	18,859	57.7%
27	Washoe County	7th	18,681	55.6%
28	Clark County	16th	17,641	57.1%
29	Balance of State	6th	17,232	55.2%
30	Clark County	17th	16,571	56.7%
31	Washoe County	8th	16,178	54.8%
32	Clark County	18th	15,623	56.3%
33	Clark County	19th	14,778	57.6%
34	Balance of State	7th	14,563	55.9%
35	Washoe County	9th	14,268	54.3%
36	Clark County	20th	14,019	55.6%
37	Clark County	21st	13,335	56.8%
38	Washoe County	10th	12,762	55.3%
39	Clark County	22nd	12,715	56.4%

<u>Seat</u>				<u>Percent Clark County Control</u>
40	Balance of State	8th	12,612	55.0%
41	Clark County	23rd	12,149	56.1%
42	Clark County	24th	11,632	57.1%
43	Washoe County	11th	11,543	55.8%
44	Clark County	25th	11,157	56.8%
45	Balance of State	9th	11,123	55.6%
46	Clark County	26th	10,719	56.5%
47	Washoe County	12th	10,538	55.3%
48	Clark County	27th	10,315	56.3%
49	Balance of State	10th	9,949	55.1%
50	Clark County	28th	9,939	56.0%
51	Washoe County	13th	9,693	54.9%
52	Clark County	29th	9,591	55.8%
53	Clark County	30th	9,265	56.6%
54	Balance of State	11th	8,999	55.6%
55	Washoe County	14th	8,974	54.5%
56	Clark County	31st	8,961	55.4%

<u>SEATS</u>	<u>CLARK</u>	<u>%</u>	<u>WASHOE</u>	<u>%</u>	<u>BALANCE</u>	<u>%</u>	<u>NOTES</u>
15	8	53.0	4	26.7	3	20.0	3-103 20
16	9	56.3	4	25.0	3	18.8	
17	10	58.8	4	23.5	3	17.6	Clark County, 273,288 55.9%
18	10	55.6	4	22.2	4	22.2	
19	10	52.6	5	26.3	4	21.1	
20	11	55.0	5	25.0	4	20.0	
21	12	57.1	5	23.8	4	19.0	
22	12	54.5	6	27.3	4	18.2	
23	13	56.5	6	26.1	4	17.4	Washoe County, 121,068 24.8%
24	13	54.2	6	25.0	5	20.8	
25	14	56.0	6	24.0	5	20.0	
30	17	56.7	7	23.3	6	20.0	
31	17	54.8	8	25.8	6	19.4	Balance of Stat 94,38 19.3
32	18	56.3	8	25.0	6	18.8	
33	19	57.6	8	24.2	6	18.2	
34	19	55.9	8	23.5	7	20.6	
35	19	54.3	9	25.7	7	20.0	
36	20	55.6	9	25.0	7	19.4	Rounded off to nearest %--will not always add to 100%.
37	21	56.8	9	24.3	7	18.9	
38	21	55.3	10	26.3	7	18.4	
39	22	56.4	10	25.6	7	17.9	
40	22	55.0	10	25.0	8	20.0	
41	23	56.1	10	24.4	8	19.5	
42	24	57.1	10	23.8	8	19.0	
43	24	55.8	11	25.6	8	18.6	
44	25	56.8	11	25.0	8	18.2	
45	25	55.6	11	24.4	9	20.0	
46	26	56.5	11	23.9	9	19.6	
47	26	55.3	12	25.5	9	19.1	
48	27	56.3	12	25.0	9	18.8	
49	27	55.1	12	24.5	10	20.4	
50	28	56.0	12	24.0	10	20.0	
51	28	54.9	13	25.5	10	19.6	
52	29	55.8	13	25.0	10	19.2	
53	30	56.6	13	24.5	10	18.9	
54	30	55.6	13	24.1	11	20.4	
55	30	54.5	14	25.5	11	20.0	
56	31	55.4	14	25.0	11	19.6	